

ALL SOULS Cemetery

Chardon, Ohio

Section 3 PART 1

SECTION NOTES

- 1 THE LOT NUMBER IS PLACED IN THE UPPER RIGHT HAND CORNER OF THE LOT AS YOU FACE THE LOT AND IS INDICATED AS A SLASH OR TICK MARK.
- 2 THE LOCATION OF GRAVE MARKERS ARE SHOWN BELOW WITH ARROW INDICATING DIRECTION GRAVE MARKERS WILL FACE.



- 3 ALL LOTS ARE 2-GRAVE LOTS UNLESS OTHERWISE NOTED ON THE DRAWING.
- 4 ALL 2-GRAVE LOTS ARE 6.0' X 9.0' ALL 3-GRAVE LOTS ARE 9.0' X 9.0'
- 5 ALL GRAVES ARE FLUSH MARKERS ONLY

LEGEND

- TREE LOCATIONS INDICATED IN GREEN
- INDICATES DIRECTION MARKERS WILL FACE.

LOT SUMMARY

142	2-GRAVE LOTS
2	3-GRAVE LOTS
290	GRAVES
3124	TOTAL GRAVES

OWNER	
Lot No.	Expire Date

NOTES
 THE CONTRACTOR SHALL VERIFY EXISTING CONDITIONS TO INSURE THAT THE NEW GRAVES WILL FIT IN THE EXISTING BOUNDS OF THE LOT. THE CONTRACTOR SHALL VERIFY THE EXISTING GRAVE MARKERS AND REMOVE THEM IF NECESSARY. THE CONTRACTOR SHALL VERIFY THE EXISTING UTILITY LINES AND REMOVE THEM IF NECESSARY. THE CONTRACTOR SHALL VERIFY THE EXISTING GRAVE MARKERS AND REMOVE THEM IF NECESSARY. THE CONTRACTOR SHALL VERIFY THE EXISTING GRAVE MARKERS AND REMOVE THEM IF NECESSARY.

CCA Catholic Cemeteries Association
 CONSTRUCTION AND FACILITIES
 10200 Main Ave., Chardon, Ohio 44024
 (216) 841-7970 Fax: (216) 841-2212



SHEET TITLE
 GRAVE LAYOUT SECTION 3

DATE 10/14/11	SHEET 118
DRAWN BY: JAC	CHECKED BY:
DESIGNED BY:	DATE 04/11/11
SCALE:	ASB

Section 2

PART 2

MAIN ENTRANCE DRIVE
PART 1

PART 3

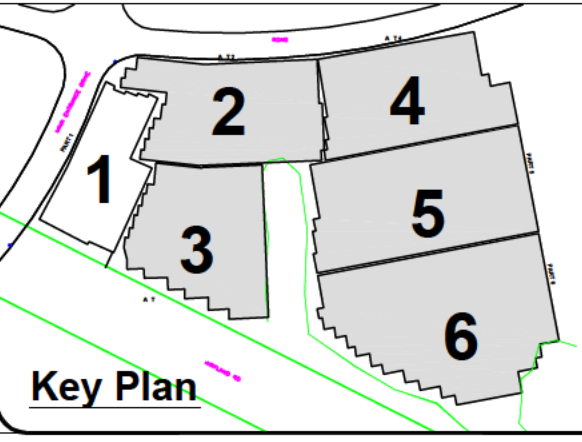

Key Plan

Section 16

PART 2

ALL SOULS

Cemetery

Chardon, Ohio

Section 3
PART 2

SECTION NOTES

① THE LOT NUMBER IS PLACED IN THE UPPER RIGHT HAND CORNER OF THE LOT AS YOU FACE THE LOT AND IS INDICATED AS A SLASH OR TICK MARK.

② THE LOCATION OF GRAVE MARKERS ARE SHOWN BELOW WITH ARROW INDICATING DIRECTION GRAVE MARKERS WILL FACE.



③ ALL LOTS ARE 2-GRAVE LOTS UNLESS OTHERWISE NOTED ON THE DRAWING.

④ ALL 2-GRAVE LOTS ARE 6.0' X 9.0'
ALL 3-GRAVE LOTS ARE 9.0' X 9.0'

⑤ ALL GRAVES ARE FLUSH MARKERS ONLY

LEGEND

TREE LOCATIONS INDICATED IN GREEN
 INDICATES DIRECTION MARKERS WILL FACE.

LOT SUMMARY

217 2-GRAVE LOTS
12 3-GRAVE LOTS
470 GRAVES
3124 TOTAL GRAVES

REL. DATE	ISSUED

NOTES
THE CONSTRUCTION SHALL BE IN ACCORDANCE WITH THE STANDARD SPECIFICATIONS FOR GRAVE MARKERS AND FACILITIES... (text is small and partially illegible)

CCA
Cemeteries Association
CONSTRUCTION AND FACILITIES
1000 West Ave., Chardon, Ohio 44024
(216) 641-7515 Fax: (216) 641-2212



NEED TITLE
GRAVE LAYOUT SECTION 3

DATE	SCALE	SHEET NO.

CONTRACTOR: **ASC** SHEET NO. **3 OF 7**

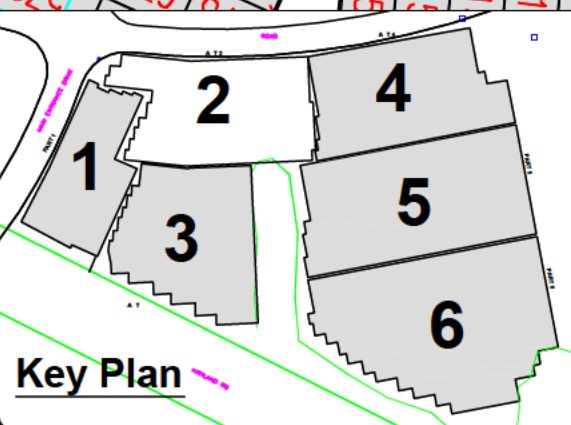
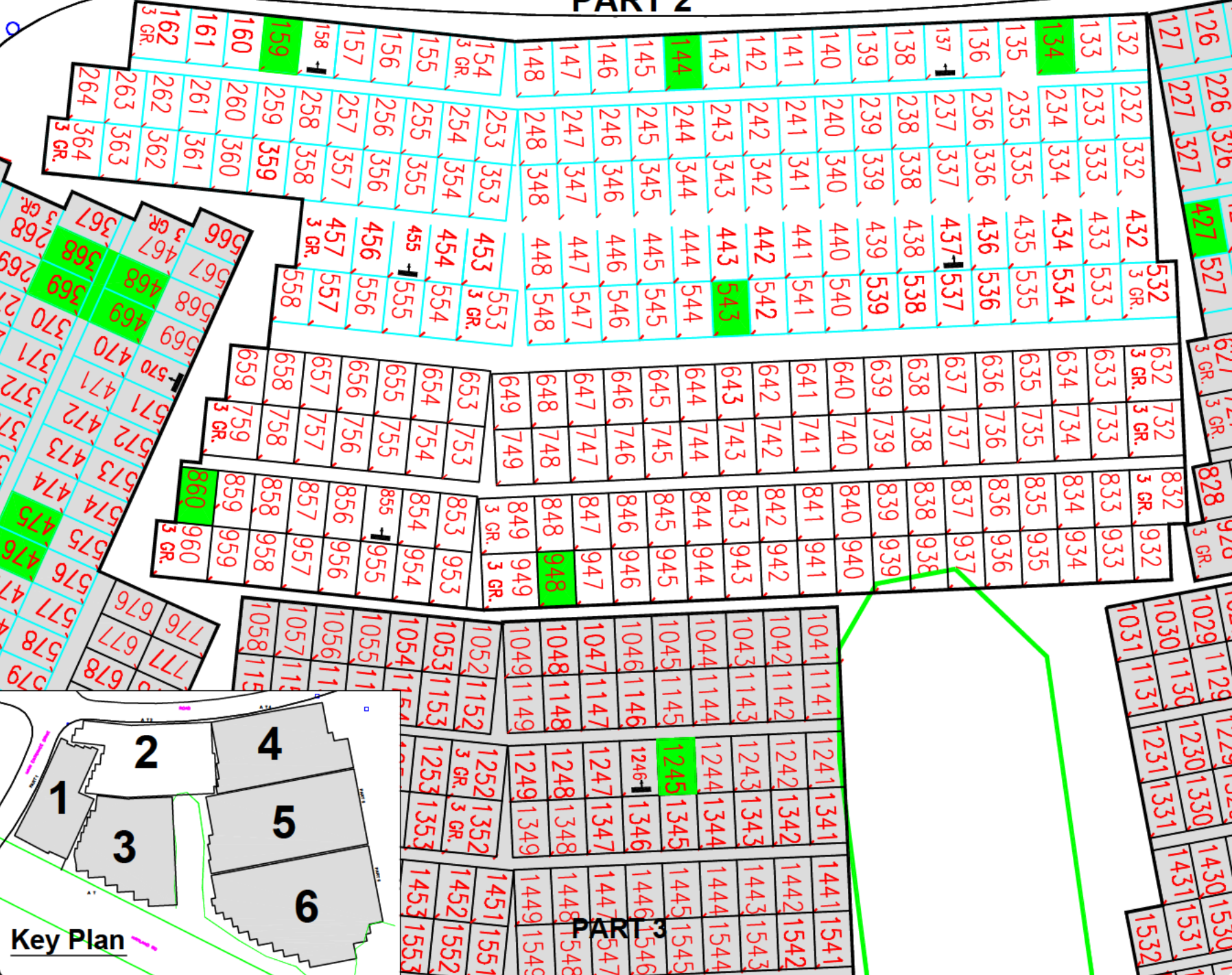

Key Plan

PART 3

Section 16

PART 4

Section 4

ALL SOULS Cemetery

Chardon, Ohio

Section 3 PART 4

SECTION NOTES

- 1 THE LOT NUMBER IS PLACED IN THE UPPER RIGHT HAND CORNER OF THE LOT AS YOU FACE THE LOT AND IS INDICATED AS A SLASH OR TICK MARK.
- 2 THE LOCATION OF GRAVE MARKERS ARE SHOWN BELOW WITH ARROW INDICATING DIRECTION GRAVE MARKERS WILL FACE.
- 3 ALL LOTS ARE 2-GRAVE LOTS UNLESS OTHERWISE NOTED ON THE DRAWING.
- 4 ALL 2-GRAVE LOTS ARE 6.0' x 9.0'. ALL 3-GRAVE LOTS ARE 9.0' x 9.0'.
- 5 ALL GRAVES ARE FLUSH MARKERS ONLY.



LEGEND

- LOT# TREE LOCATIONS INDICATED IN GREEN
- INDICATES DIRECTION GRAVE MARKERS WILL FACE.

LOT SUMMARY

232 2-GRAVE LOTS
 3 3-GRAVE LOTS
 473 GRAVES
 3124 TOTAL GRAVES

ISSUED

DATE DESCRIPTION

NOTES
 The contractor shall verify existing conditions to ensure that the site is suitable for the proposed improvements. The contractor shall be responsible for obtaining all necessary permits and approvals. The contractor shall maintain access to all adjacent properties at all times. The contractor shall be responsible for any and all utility relocation and other matters related to the site.

CCA Catholic Cemetery Association
 CONSTRUCTION AND FACILITIES
 15000 Miles Ave., Chardon, Ohio 44024
 (216) 281-7676 Fax: (216) 281-2012



SHEET TITLE
GRAVE LAYOUT SECTION 3

DATE 10/24/11 SCALE 1/8" = 1'-0"
 DRAWN BY JAC/MLC CHECKED BY JAC/MLC
 COUNTY CUYAHOGA SHEET NO. 5 OF 7

132	232	332	432	532	632	732	832	932
133	233	333	433	533	633	733	833	933
134	234	334	434	534	634	734	834	934

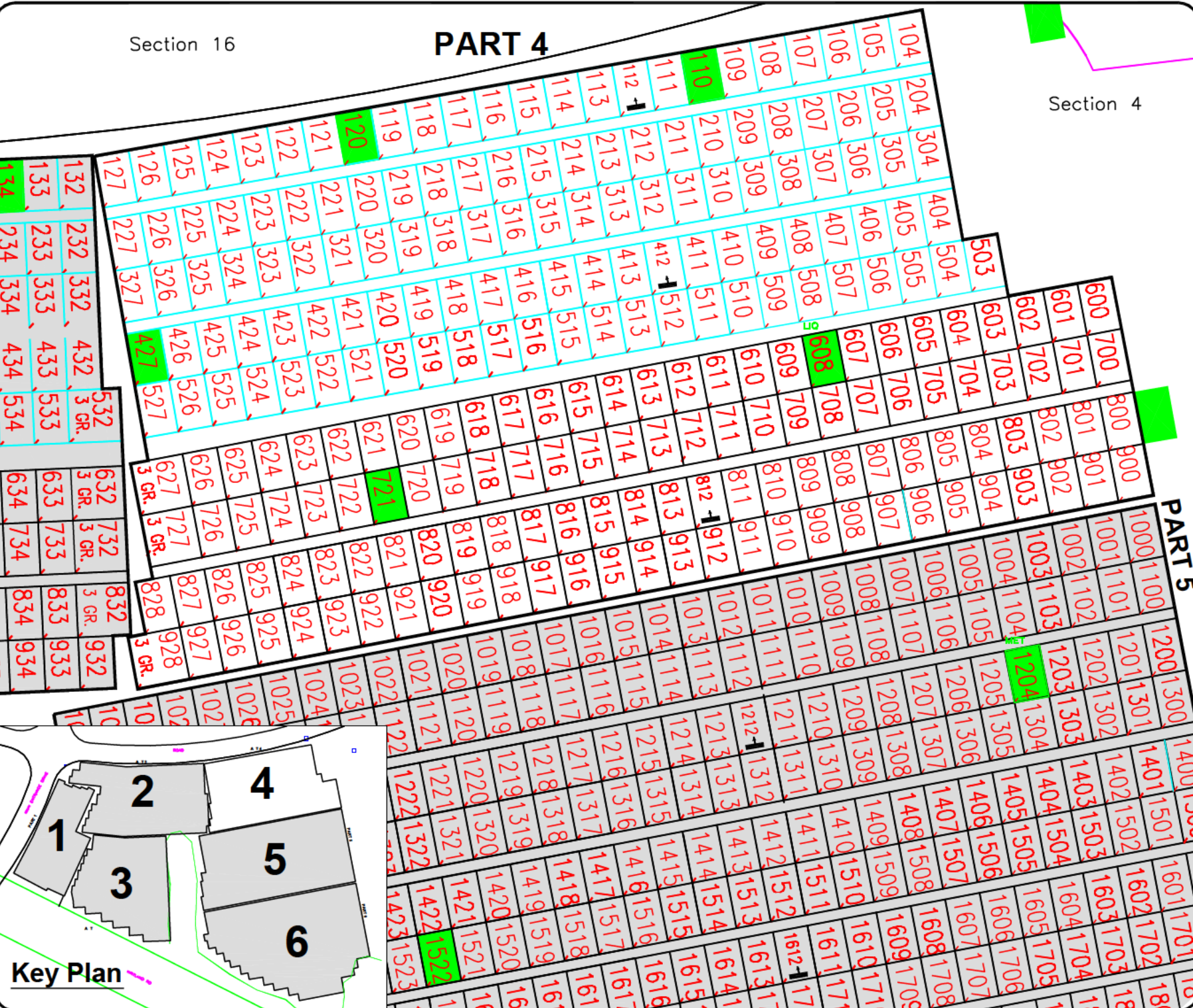
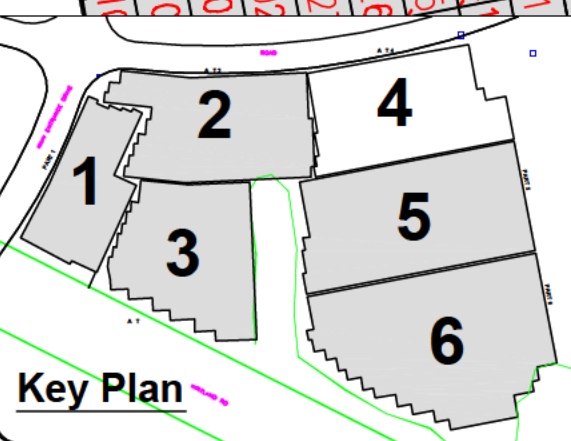

ALL SOULS Cemetery

Section 3 PART 5

SECTION NOTES

- 1 THE LOT NUMBER IS PLACED IN THE UPPER RIGHT HAND CORNER OF THE LOT AS YOU FACE THE LOT AND IS INDICATED AS A SLASH OR TICK MARK.
- 2 THE LOCATION OF GRAVE MARKERS ARE SHOWN BELOW WITH ARROW INDICATING DIRECTION GRAVE MARKERS WILL FACE.
- 3 ALL LOTS ARE 2-GRAVE LOTS UNLESS OTHERWISE NOTED ON THE DRAWING.
- 4 ALL 2-GRAVE LOTS ARE 6.0' x 9.0' ALL 3-GRAVE LOTS ARE 9.0' x 9.0'
- 5 ALL GRAVES ARE FLUSH MARKERS ONLY



LEGEND

- 1227 TREE LOCATIONS INDICATED IN GREEN
- ↓ INDICATES DIRECTION GRAVE MARKERS WILL FACE.

LOT SUMMARY

325 2-GRAVE LOTS
 2 3-GRAVE LOTS
 656 GRAVES
 3124 TOTAL GRAVES

NOTES

THE CONSTRUCTION SHALL BE DONE IN ACCORDANCE WITH THE CITY OF CHARDON, OHIO, ZONING ORDINANCE AND THE CITY OF CHARDON, OHIO, PUBLIC WORKS DEPARTMENT. THE CONTRACTOR SHALL BE RESPONSIBLE FOR OBTAINING ALL NECESSARY PERMITS AND APPROVALS FROM THE CITY OF CHARDON, OHIO, PUBLIC WORKS DEPARTMENT. THE CONTRACTOR SHALL BE RESPONSIBLE FOR OBTAINING ALL NECESSARY PERMITS AND APPROVALS FROM THE CITY OF CHARDON, OHIO, PUBLIC WORKS DEPARTMENT.

CCA Catholic Cemetery Association
 CONSTRUCTION AND FACILITIES
 10000 Mile Ave., Cleveland, Ohio 44108
 (216) 841-7975 Fax: (216) 841-0212



SHOW THE GRAVE LAYOUT SECTION 3

DATE	SCALE	REV.
ASC		6 OF 7

Section 4

PART 5

PART 6

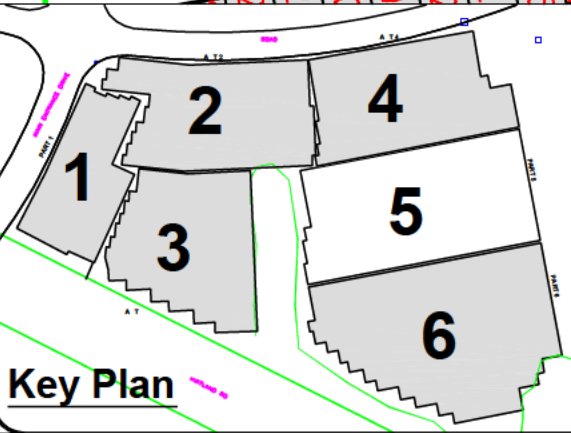

Key Plan

