



1" = 10'-0"

08/24/04-13

PROJECT NO. 1

DATE: 08/24/04

04-section 3

SHEET NAME

St. Mary's E. 71 St.
Section 3
Whole Part

Catholic Cemeteries
1000 Miles Avenue
Cleveland, Ohio 44105
216-641-7575

SECTION NOTES

- The lot number is placed in the upper right hand corner of the lot as you face the lot and is indicated as a slash or tick mark.
- The location of grave markers are shown below with arrow indicating directly grave markers will face.
- All lots are 2 grave lots unless otherwise noted on the drawing.
- All 2 grave lots are 6' x 9'. All 3 grave lots are 9' x 9'. Only flush markers allowed within the first two rows.
- All graves are designated as ordinary depth only.



MONUMENT SUMMARY

The following lots have been designated as monument lots:

Lots 2042 through 2058
 Lots 1642 through 1656.
 Lots 1242 through 1258.
 Lots 842 through 858.
 Lots 442 through 458.

Total of (81) 2 grave lots or 162 total graves.

All monuments will be placed in a two foot path located directly above each lot.

LOT SUMMARY

81 2 grave monument lots
 262 2 grave flush or pillow monument lots.
 686 Total graves

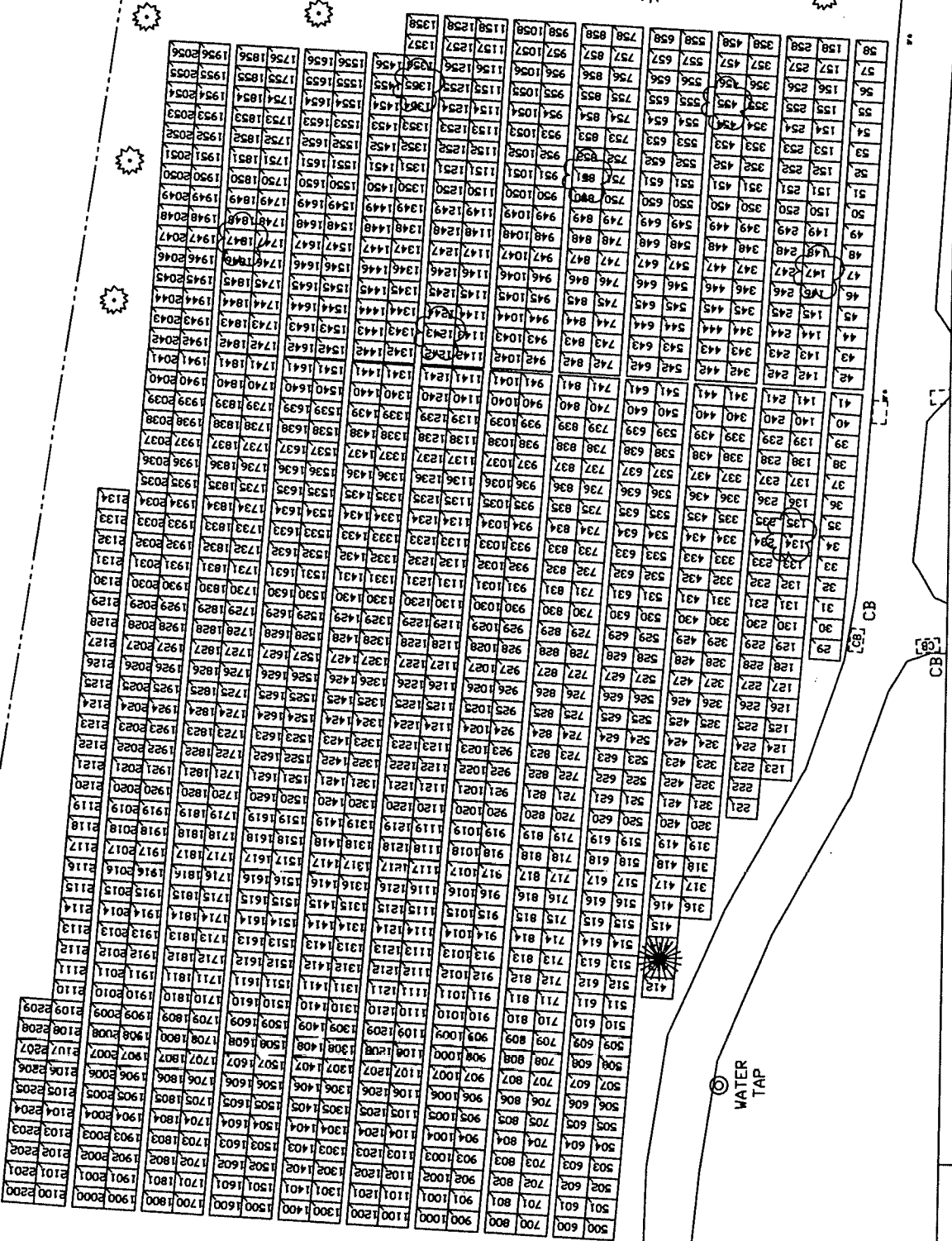

1" = 10'-0"